

- F NOTICE DE MONTAGE
- GB INSTALLATION INSTRUCTIONS
- D MONTAGEANLEITUNG
- E INSTRUCCIONES DE MONTAJE
- P INSTRUÇÕES DE MONTAGEM
- I ISTRUZIONI DI MONTAGGIO
- NL MONTAGEHANDLEIDING

Ref 3414 - 3416

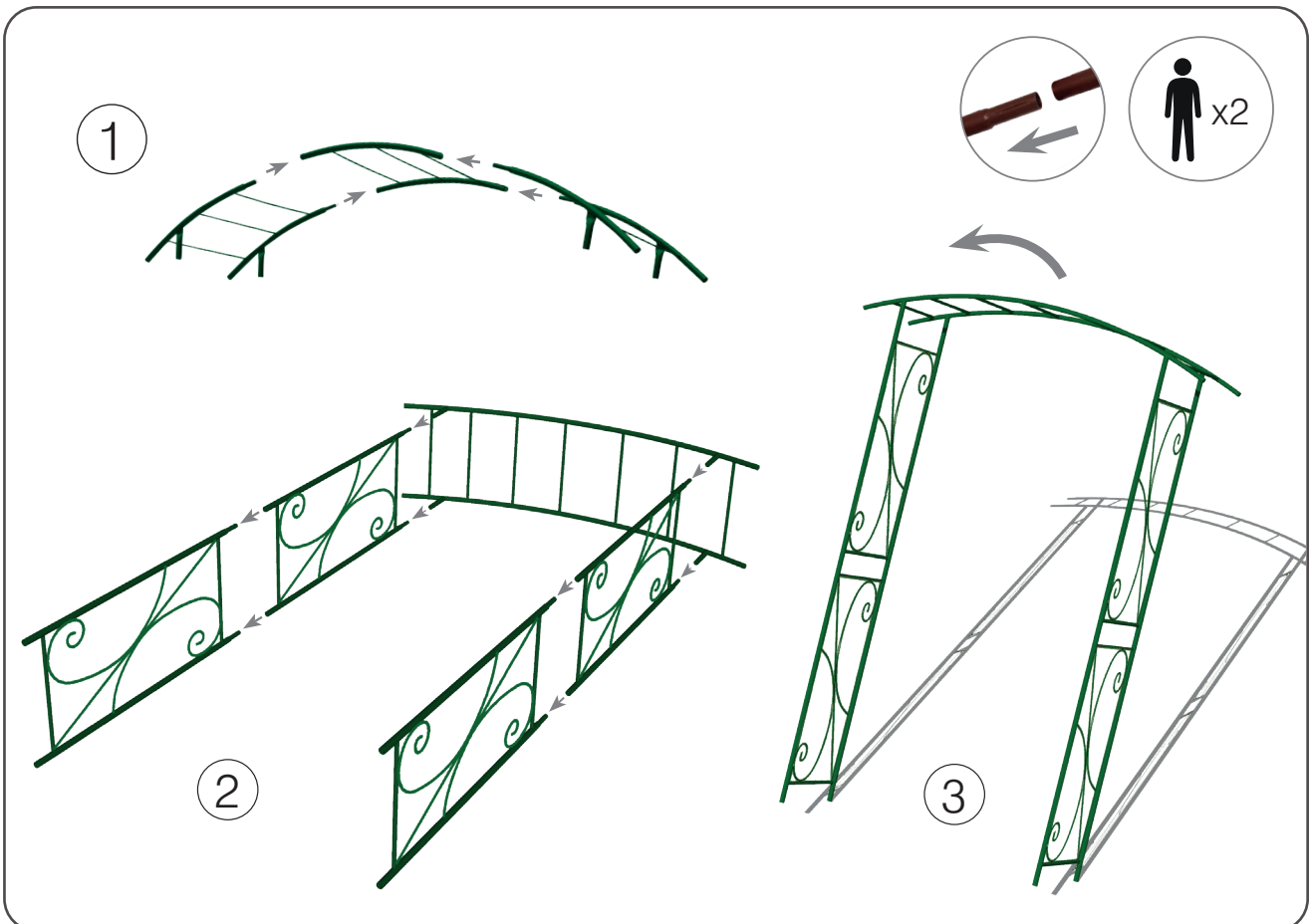
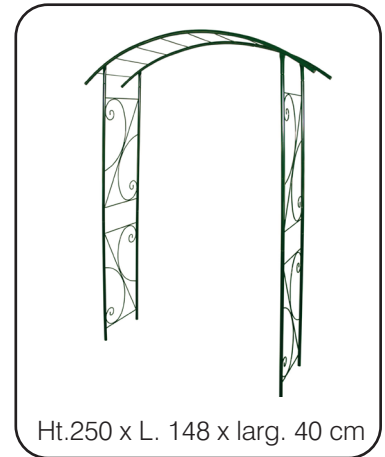
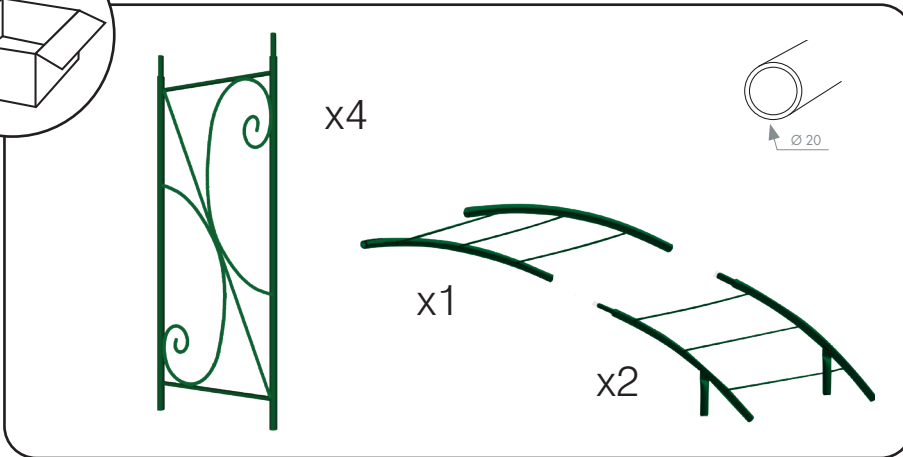
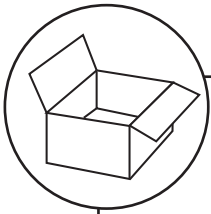

Pour assurer une stabilité maximum utiliser les accessoires de fixation.

To ensure maximum stability use the fixing accessories.



Ref. 3316 (x4)
Ref. 3314 (x4)



Ref. 3326 (x4)
Ref. 3324 (x4)